

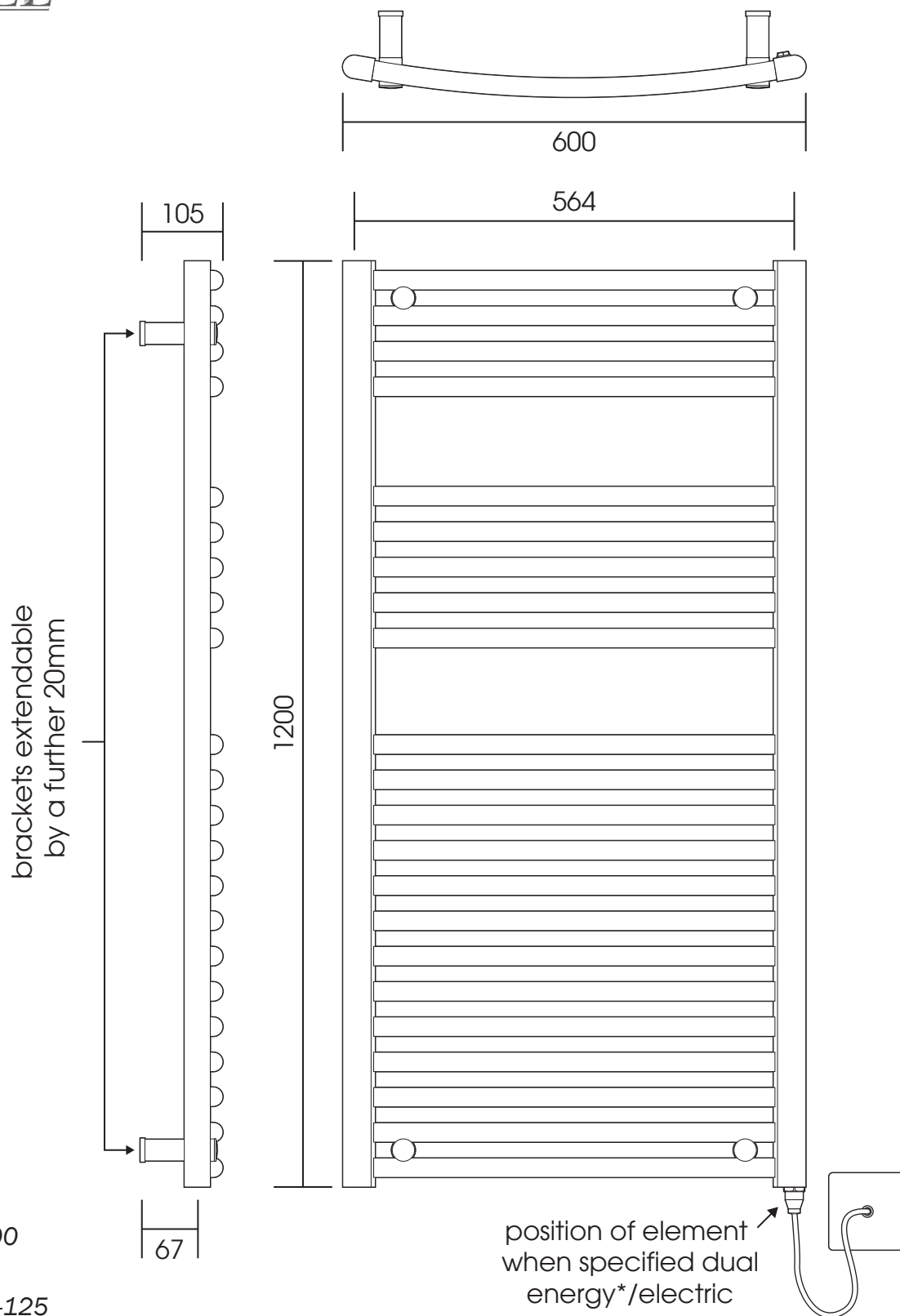

JMC12060



Height: 1200

Width: 600

Depth: 105-125

Tube \varnothing : 25 + 30 x 40 D section

Output @ 50°C Δ T: 710 W

Elec. element when specified: 400 W

position of element
when specified dual
energy*/electric

*Dual energy models require a conversion-tee, consult relevant drawing for details.
Brackets supplied may differ from those depicted

Jumel reserve the right to alter specifications without prior notice.
All measurements given are nominal dimensions only.

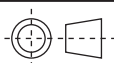

SCALE 1:8

All dimensions in millimetres

Jumel Division of Towel Rails 2 Go Ltd, Unit M, Key Industrial Park, Fernside Road, Wolverhampton, West Midlands, WV13 3YA
Tel: 01902 387099 - Fax: 01902 387098 - Email: sales@jumel.co.uk